

Requires prior installation of Excel Life with Netatmo Gateway or Starter Kit:

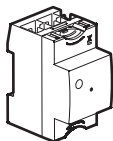

DIN-rail Gateway
(Cat no. 412181)

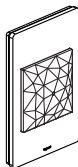
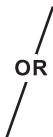

Starter kit
(EWNKIT series)

Pack contents

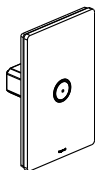

OR

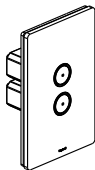

OR

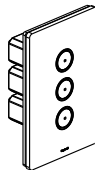

Smart switch 3 wire

Characteristics

In default operating mode (on/off), this switch works with the following bulbs:

+45°C +5°C			LED 			(**)
100-240 VAC 50/60 Hz	1 x 2.5mm ²					
240 VAC	Max.	500 W	(*)100 W	100 W	250 VA	250 VA
100 VAC	Max.	250 W	(*) 50 W	50 W	125 VA	125 VA

(*) Or 10 lamps max. For a good light comfort, it is recommended to use bulbs of the same type and the same manufacturer.

(**) Use only with transformers designed to work with electronic switches.

Take account of transformer losses when calculating power.

Transformers must be loaded at more than 60% of their power.

Before you start: Multi-way switching configuration.



Do not use: two smart switches to control the same lighting point.

If you plan to install two-way switching, read the following :

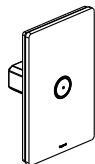

Smart switch
x 1

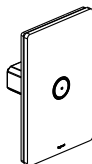

Smart switch
x 1

AND

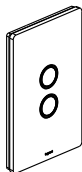

x 1
or more

EWNWSW1 series

Wireless switch
(not included in this pack)

OR



EM770 series

OR

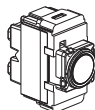

EM970 series

x 1
or more

Mechanical 2-way switch
(not included in this pack)

Recommendation if replacing a two-way switch using a wireless switch (EWNWSW1 series):

old flush-mounted switch replaced by the wireless switch.

Use a **Connector** (Cat no.401 or equivalent) to connect Active wire and Switched Active wires.

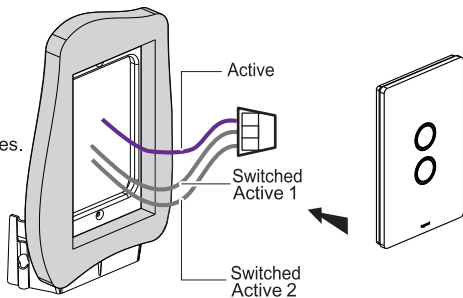

① Necessary safety precautions

1



Switch OFF the power at the main circuit breaker

OFF

2



Make sure that the power is OFF before continuing with the installation.

② Install the smart switch

① Remove the existing switch

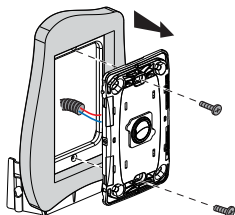

② Wire the smart switch

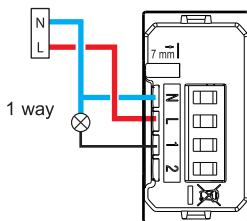

② Wire the smart switch

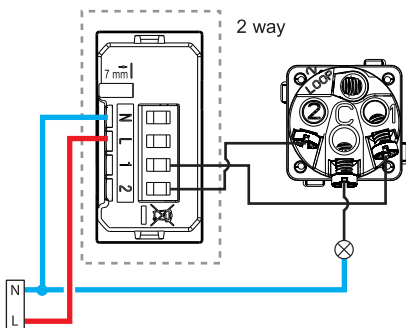

— N (neutral) = blue
— L (live) = any except blue and green/yellow

③ Install the smart switch

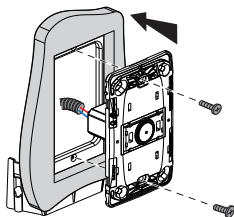

Frequency bands: 2.4 - 2.4835 GHz
Power level: < 100 mW

③ **To add a smart product to your smart installation, you should follow the instructions:**

- in the **user guide in your Starter kit**
- in the **Legrand Home + Control application (Settings/Add a new product section)**
- or consult the user manual on **<http://ecat.legrand.com.au/>**



Legrand - Australia 1300 369 777

www.legrand.com.au

Legrand - New Zealand 0800 476 009

www.legrand.co.nz

 **Safety instructions**

This product should be installed in compliance with installation rules, preferably by a qualified electrician. Incorrect installation and/or incorrect use can lead to risk of electric shock or fire. Before carrying out the installation, read the instructions and take account of the product's specific mounting location.

Do not open up, dismantle, alter or modify the device except where specifically required to do so by the instructions. All Legrand products must be opened and repaired exclusively by personnel trained and approved by Legrand. Any unauthorised opening or repair completely cancels all liabilities and the rights to replacement and guarantees. Use only Legrand brand accessories.

Warranty

Legrand Australia Pty Ltd warrants this product for a period of 12 months from the date of purchase. These goods come with guarantees that cannot be excluded under the Australian and New Zealand Consumer Laws. You are entitled to a replacement or a refund for a major failure and compensation for any other reasonably foreseeable loss or damage. You are also entitled to have the goods repaired or replaced if the goods fail to be of acceptable quality and the failure does not amount to a major failure.